

PLOTTED: 31-OCT-2023 08:09

OPERATOR: Tolley/CM
FILE NAME: pw://stvpw.bentley.com:stvpw-01/Documents/Workset/Drawings/Civil/670462061_5&PM Plan.dgn

DISTRICT	COUNTY	ROUTE	SECTION	SHEET
8-0	YORK	0462	061	1 OF 2
CITY OF YORK				
REV NO	REVISIONS	DATE	BY	APPD

LEGEND

- ⊥ EXISTING SIGN
- ⊥ PROPOSED SIGN
- BW/4" EXISTING BROKEN WHITE LINE / WIDTH
- Y/4" SINGLE YELLOW LINE / WIDTH
- DY/4" DOUBLE YELLOW LINE / WIDTH
- W/12" SOLID WHITE LINE / WIDTH
- BW/4" BROKEN WHITE LINE / WIDTH
- DTW/8" DOTTED EXTENSION WHITE LINE / WIDTH

NOTE:
FOR PAVEMENT MARKINGS FIRST APPLY ONE COAT OF STANDARD PAVEMENT MARKINGS, PAINT & BEADS, THEN APPLY ONE COAT OF WATERBORNE PAVEMENT MARKINGS

GENERAL NOTES

CONTRACTOR SHALL BE RESPONSIBLE FOR RECORDING, STAKING OUT, AND SUPPLYING THE INSPECTOR-IN-CHARGE WITH DOCUMENTATION OF THE EXISTING TYPE, SIZE, AND LOCATION OF ALL TRAFFIC PAVEMENT MARKINGS, AND LEGENDS PRIOR TO MILLING AND/OR RESURFACING. THE INSPECTOR-IN-CHARGE IS TO VERIFY THAT THIS HAS BEEN DONE BEFORE ANY MILLING OR RESURFACING BEGINS.

GOVERNING PUBLICATIONS FOR SIGNING AND PAVEMENT MARKING OPERATIONS ARE AS FOLLOWS:

1. FHWA - MANUAL ON UNIFORM TRAFFIC CONTROL DEVICES (MUTCD)
2. PDT PUB. 35 - APPROVED CONSTRUCTION MATERIALS (BULLETIN 15)
3. PDT PUB. 46 - TRAFFIC ENGINEERING MANUAL
4. PDT PUB. 111 - PAVEMENT MARKING AND SIGNING STANDARDS, TC-8600 AND TC-8700 SERIES
5. PDT PUB. 236 - HANDBOOK OF APPROVED SIGNS
6. PDT PUB. 408 - HIGHWAY CONSTRUCTION SPECIFICATIONS

ALL STATIONS ARE APPROXIMATE.

REMOVE EXISTING SIGNS IN ACCORDANCE WITH PDT PUB. 408 SECTIONS 930, 931, 932, 934, 935 AND/OR 936. SIGN FOUNDATIONS TO BE REMOVED 12" BELOW FINAL GRADE, PER PDT PUB. 408 SECTION 930.3(c).

THE CONTRACTOR SHALL PREPARE THE PAVEMENT SURFACE FOR PROPER ADHESION. ANY SWEEPING OR REMOVAL OF DEBRIS, GRAVEL, DIRT, OR OTHER FOREIGN MATERIALS SHALL BE CONSIDERED INCIDENTAL TO INSTALLATION OF THE NEW PAVEMENT MARKINGS.

FINAL APPLICATION OF WHITE AND YELLOW WATERBORNE PAVEMENT MARKINGS SHALL BE AFTER COMPLETION OF ALL ASSOCIATED PROJECT ROADWAY/PROJECT CLEAN-UP.

UNLESS OTHERWISE SPECIFIED, EXISTING SIGNS DISTURBED DURING CONSTRUCTION SHALL BE PROMPTLY REPLACED BY CONTRACTOR.

DETAILS OTHER THAN THOSE INDICATED ARE ON THE FOLLOWING STANDARD DRAWINGS:

- TC-8600 JUNE 13, 2013
- TC-8604 AUG 17, 2021
- TC 8702B JUNE 13, 2013

REFER TO PDT PUB. 111, TC-8604, FOR DELINEATION PLACEMENT DETAILS. IN AREAS WITHOUT CURBING AND IN AREAS WITH EDGE LINES, MATCH ALL REFLECTIVE SHEETING COLORS WITH THE NEAREST PAVEMENT MARKING EDGE LINE COLOR. REMOVE ALL FLEXIBLE DELINEATOR POSTS THAT DO NOT HAVE PROPER POST OR REFLECTIVE SHEETING COLOR OR ARE BEHIND OR NEAR NEW GUIDE RAIL, ALONG WITH OTHER DAMAGED OR WORN OUT POSTS.

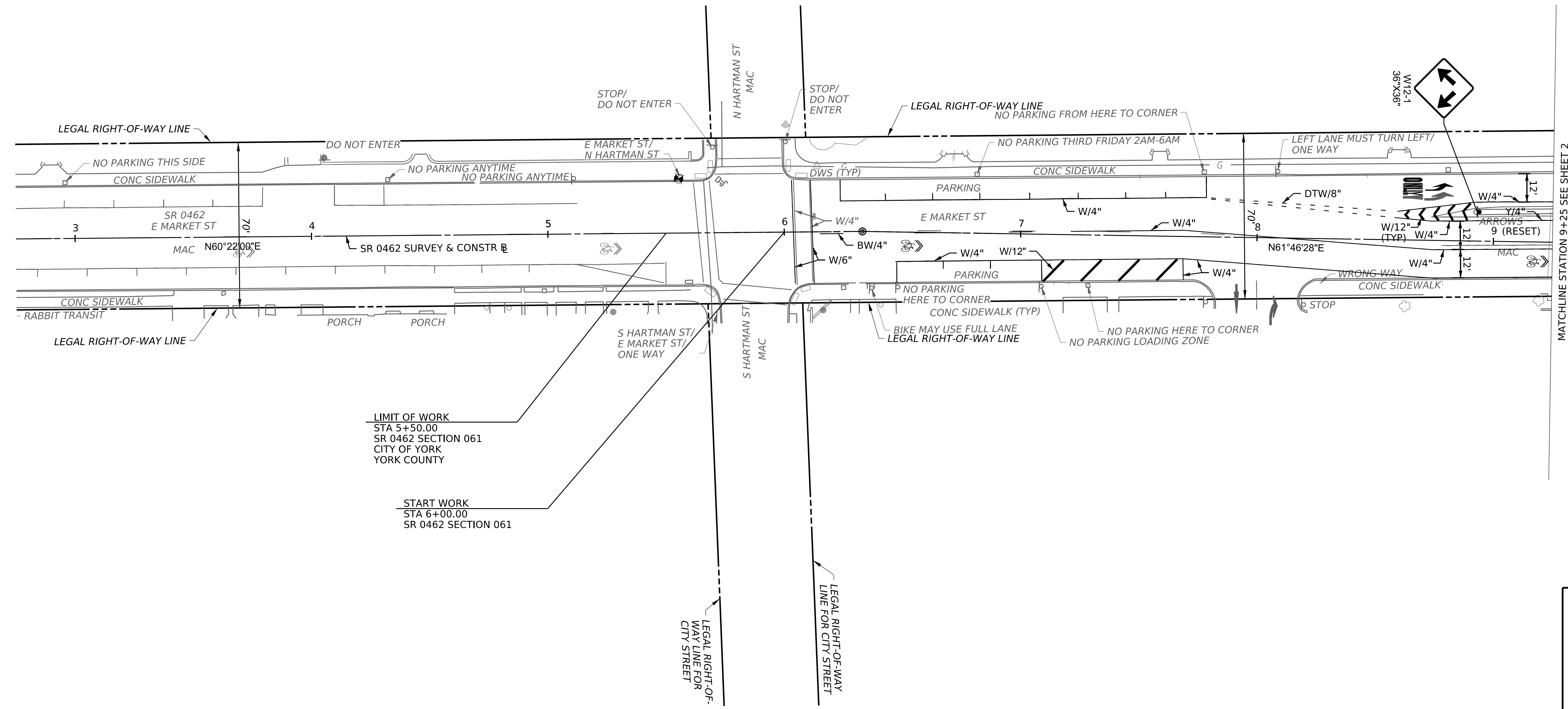
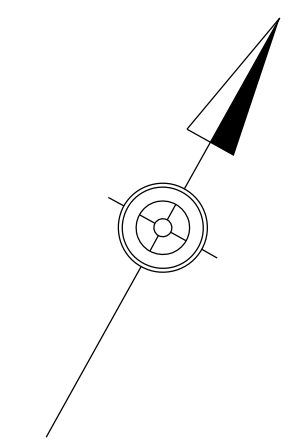

LIMIT OF WORK
STA 5+50.00
SR 0462 SECTION 061
CITY OF YORK
YORK COUNTY

START WORK
STA 6+00.00
SR 0462 SECTION 061

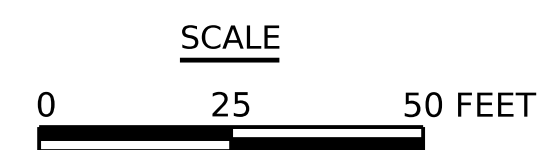

SIGNING AND PAVEMENT MARKING PLAN

RECOMMENDED: _____ DATE: _____

DISTRICT TRAFFIC ENGINEER

PLANS PREPARED BY:
STV Incorporated
CONSULTING ENGINEERS
2040 LINGESTOWN ROAD, SUITE 104
HARRISBURG, PA 17110

PROFESSIONAL ENGINEER
DATE: _____

MATCHLINE STATION 9+25 SEE SHEET 2

DISTRICT	COUNTY	ROUTE	SECTION	SHEET
8-0	YORK	0462	061	2 OF 2
SPRING GARDEN TOWNSHIP & CITY OF YORK				
REV NO	REVISIONS	DATE	BY	APPD

LEGEND

- ⊥ EXISTING SIGN
- ⊥ PROPOSED SIGN
- BW/4" EXISTING BROKEN WHITE LINE / WIDTH
- Y/4" SINGLE YELLOW LINE / WIDTH
- DY/4" DOUBLE YELLOW LINE / WIDTH
- W/12" SOLID WHITE LINE / WIDTH
- BW/4" BROKEN WHITE LINE / WIDTH
- DTW/8" DOTTED EXTENSION WHITE LINE / WIDTH

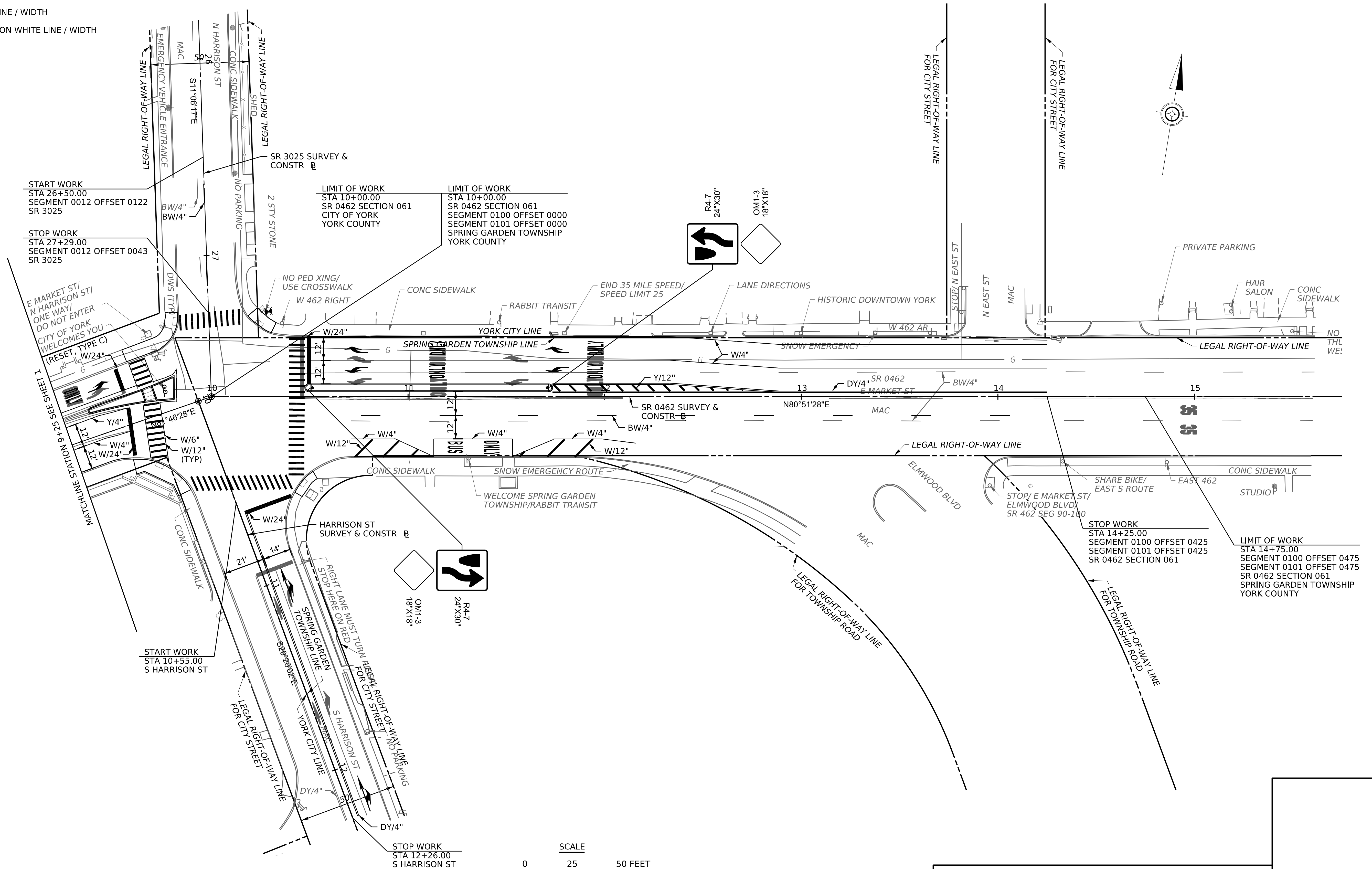

SIGNING AND PAVEMENT MARKING PLAN

PLOTTED: 31-OCT-2023 08:09

OPERATOR: Tolley/CM
FILE NAME: pw://st-pw.bentley.com:st-pw-01/Documents/Workset/Drawings/Civil/670462061_5&PM Plan.dgn